



JACKSONVILLE WASTEWATER UTILITY
248 Cloverdale Rd.
Jacksonville, AR 72076
501-982-0581

No. 06- 0200

RESIDENTIAL OR COMMERCIAL BUILDING SEWER CONNECTION PERMIT

Street Address 3000 John H. H. / Pine Meadows

Legal Description Lot 13 / Mobile Home Park

Facility to be connected to sewer:

Single Family Residence _____ *Multi-family Residential _____ Units _____

*Commercial Installation _____ Description: Repairs

Water Meter (s) Size _____

* Commercial installations, and multi-family installations of more than 4 dwelling units must be accompanied by a site plan showing the proposed building sewer.

Sewer line installation by AAA Plumbing

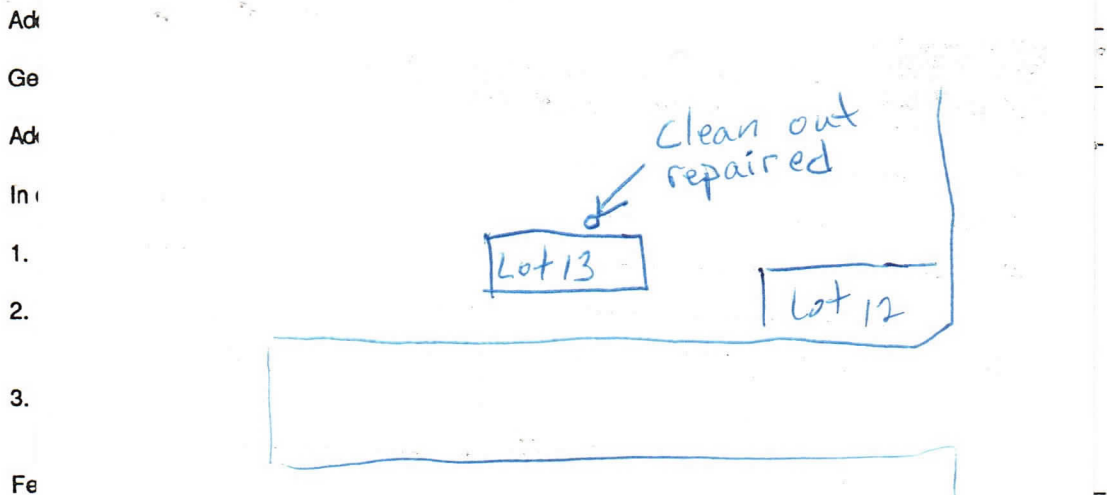

Tap Charge \$ _____

Receipt No. _____

Inspection Fee \$ 12.00

Receipt No. on file

Street Cut \$ _____

Receipt No. _____

APPLICANT

Signed Signature on file

☐ Plumbing Contractor

☐ General Contract

☐ Owner (Address _____)

APPROVED

Jacksonville Wastewater Utility

By: Jessica Kendrick

Date: 9-26-06

Inspected
9-26-06