



JACKSONVILLE WASTEWATER UTILITY

248 Cloverdale Rd.
Jacksonville, AR 72076
501-982-0581

No. 10-0000179

RESIDENTIAL OR COMMERCIAL BUILDING SEWER CONNECTION PERMIT

Street Address 3000 John Hadden

Legal Description _____

Facility to be connected to sewer:

Single Family Residence ☒ *Multi-family Residential _____ Units _____

*Commercial Installation _____ Description: Replacement

Water Meter (s) Size 5/8

* Commercial installations, and multi-family installations of more than 4 dwelling units must be accompanied by a site plan showing the proposed building sewer.

Sewer line installation by Quinn Plumbing - Travis 563-8467

Address PINE MEADOWS

General _____

Address _____

In consid _____

1. To ac 81-HW

2. To ma 81-HW
public

3. To no 81-HW
to the

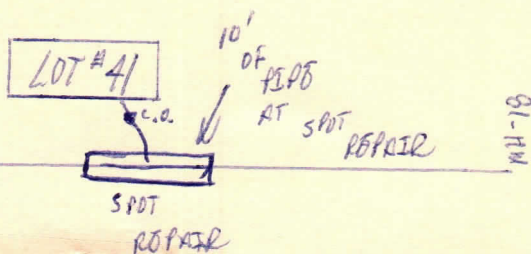

Fees: Connection Fee \$ _____ Receipt No. _____

Tap Charge \$ _____ Receipt No. _____

Inspection Fee \$ 25.00 Receipt No. maect

Street Cut \$ _____ Receipt No. _____

APPLICANT

Signed maect

☐ Plumbing Contractor

☐ General Contract

☐ Owner (Address _____)

APPROVED

Jacksonville Wastewater Utility

By: Dickens Date: 9/29/10

Complete
9/29/10