



# JACKSONVILLE WASTEWATER UTILITY

248 Cloverdale Rd.  
Jacksonville, AR 72076  
501-982-0581

No. 07-0094

## RESIDENTIAL OR COMMERCIAL BUILDING SEWER CONNECTION PERMIT

Street Address 3000 John Harden Dr

Legal Description Pine Meadows Lot 93

Facility to be connected to sewer:

Single Family Residence ☒ \*Multi-family Residential ☐ Units ☐

\*Commercial Installation ☐ Description: Repairs (3)

Water Meter (s) Size 5/8"

\* Commercial installations, and multi-family installations of more than 4 dwelling units must be accompanied by a site plan showing the proposed building sewer.

Sewer line installation by AAA Plumbing

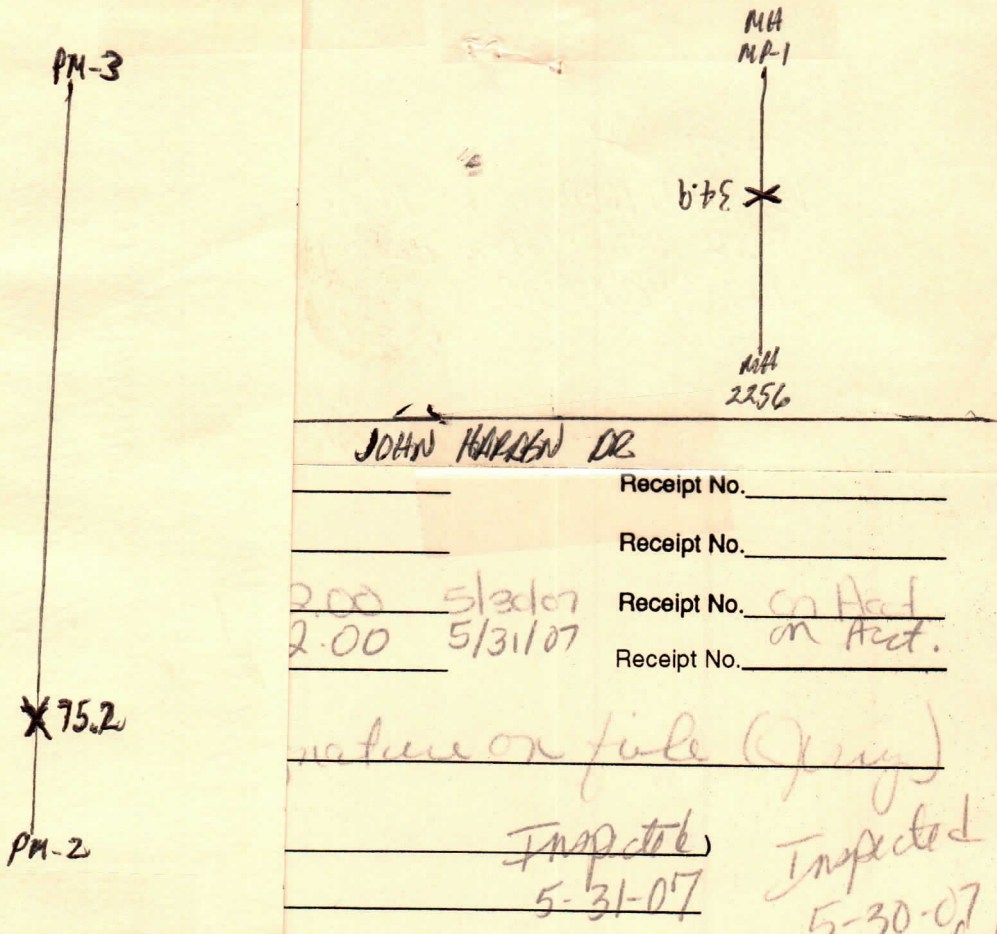

APPROVED  
Jacksonville Wastewater Utility

By: [Signature] Date: 5/30/07



JACKSONVILLE WASTEWATER UTILITY  
248 Cloverdale Rd.  
Jacksonville, AR 72076  
501-982-0581

No. 07-0095

## RESIDENTIAL OR COMMERCIAL BUILDING SEWER CONNECTION PERMIT

Street Address 3000 John Harden

Legal Description Lot 93 Pine Meadows

Facility to be connected to sewer:

Single Family Residence ☒ \*Multi-family Residential ☐ Units ☐

\*Commercial Installation ☐ Description: repair

Water Meter (s) Size 5/8"

\* Commercial installations, and multi-family installations of more than 4 dwelling units must be accompanied by a site plan showing the proposed building sewer.

Sewer line installation by AAA Plumbers

Address	<p>MH PM-1 X 19.3 MH 2256</p>
General	
Address	
In con:	
1. To	
2. To	pub
3. To	
to th	<u>JOHN HARDEN DR</u>

Fees:	Connection Fee	\$ _____	Receipt No.	_____
	Tap Charge	\$ _____	Receipt No.	_____
	Inspection Fee	\$ <u>12.00</u> <u>5/29/07</u>	Receipt No.	<u>on acct</u>
	Street Cut	\$ _____	Receipt No.	_____

### APPLICANT

Signed Signature on acct

☐ Plumbing Contractor

☐ General Contract

☐ Owner (Address \_\_\_\_\_)

### APPROVED

Jacksonville Wastewater Utility

By: Gillian Hendley Date: 5/29/07

*Inspected*  
*5-29-07*