



No. 88-00187

# JACKSONVILLE WASTEWATER UTILITY

## RESIDENTIAL OR COMMERCIAL BUILDING SEWER CONNECTION PERMIT

Street Address 619 B Nath First

Legal Description \_\_\_\_\_

Facility to be connected to sewer:

Single Family Residence \_\_\_\_\_ \*Multi-family Residential \_\_\_\_\_ Units \_\_\_\_\_

\*Commercial Installation ☒ Description: New

Water Meter (s) size \_\_\_\_\_

\*Commerical installations, and multi-family installations of more than 4 dwelling units must be accompanied by a site plan showing the proposed building sewer.

Sewer line installation by Betts Plog

Address \_\_\_\_\_

General Contractor Jim Greene

Address \_\_\_\_\_

In consideration of the granting of this permit the undersigned agrees:

1. To accept and abide by all provisions of the Jacksonville Wastewater Utility.
2. To maintain the building sewer at no expense to the Utility, to the point of connection with the public sewer main.
3. To notify the utility's inspector when the building sewer is ready for inspection and connection to the public sewer main, but before any portion of the work is covered.

Fees: Connection Fee \$ 75.00  
Tap Charge \$ 0.00  
Inspection Fee \$ 0.00  
Total Fees \$ 75.00

Receipt No. 4531/17/89

Receipt No. \_\_\_\_\_

Receipt No. \_\_\_\_\_

### APPLICANT

Signed Jim Greene

- ☐ Plumbing Contractor  
☐ General Contract  
☐ Owner (Address \_\_\_\_\_)

APPROVED  
Jacksonville Wastewater Utility

By: \_\_\_\_\_

Date: \_\_\_\_\_



No. 89- 013

## JACKSONVILLE WASTEWATER UTILITY

### RESIDENTIAL OR COMMERCIAL BUILDING SEWER CONNECTION PERMIT

Street Address 619 B North first

Legal Description \_\_\_\_\_

Facility to be connected to sewer:

Single Family Residence \_\_\_\_\_ \*Multi-family Residential \_\_\_\_\_ Units \_\_\_\_\_

\*Commercial Installation ☒ Description: new

Water Meter (s) size \_\_\_\_\_

\*Commerical installations, and multi-family installations of more than 4 dwelling units must be accompanied by a site plan showing the proposed building sewer.

Sewer line installation by Butts Abs

Add

Ger

Add

In c

1.

2.

3.

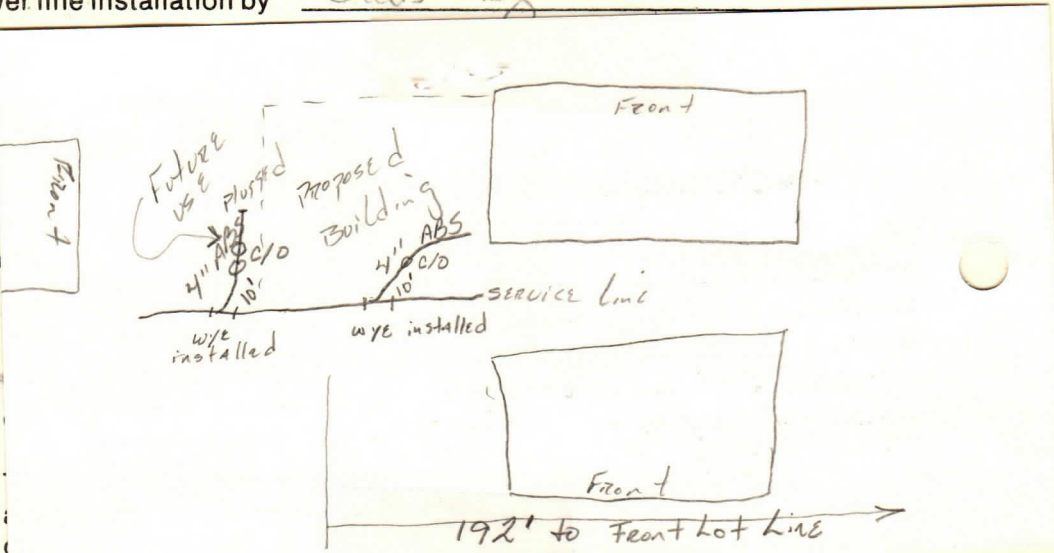

Fees: Connection Fee \$ 75.00

Receipt No. 453 1/17/89

Tap Charge \$ \_\_\_\_\_

Receipt No. \_\_\_\_\_

Inspection Fee \$ 6.00

Receipt No. 90-0398 10/4/90

Total Fees \$ 81.00

#### APPLICANT

Signed \_\_\_\_\_

☐ Plumbing Contractor

☐ General Contract

☐ Owner (Address \_\_\_\_\_)

#### APPROVED

Jacksonville Wastewater Utility

By: \_\_\_\_\_

Date: \_\_\_\_\_