



JACKSONVILLE WASTEWATER UTILITY  
248 Cloverdale Rd.  
Jacksonville, AR 72076  
501-982-0581

No. 17-148

RESIDENTIAL OR COMMERCIAL BUILDING SEWER CONNECTION PERMIT

Street Address 203 Palm St

Legal Description Graham Woods II 10E47

Facility to be connected to sewer:

Single Family Residence ☒ \*Multi-family Residential ☐ Units ☐

\*Commercial Installation ☐ Description: New Connection

Water Meter (s) Size 3/8"

\* Commercial installations, and multi-family installations of more than 4 dwelling units must be accompanied by a site plan showing the proposed building sewer.

Sewer line installation by Kimbel Mechanical GABE  
5932443

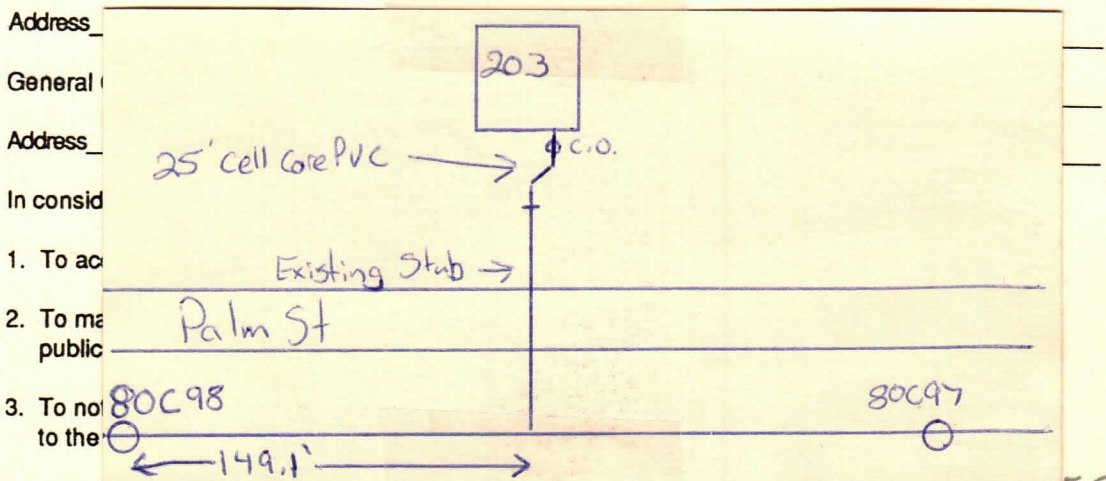

Fees: Connection Fee \$ 1500

Receipt No. 177552

Tap Charge \$ \_\_\_\_\_

Receipt No. \_\_\_\_\_

Inspection Fee \$ 2500 *10/6/17*

Receipt No. 174375

Street Cut \$ \_\_\_\_\_

Receipt No. \_\_\_\_\_

APPLICANT  
Signed Barbara V. Sander

☐ Plumbing Contractor

☐ General Contract

☐ Owner (Address \_\_\_\_\_)

*complete  
10/6/17*

APPROVED  
Jacksonville Wastewater Utility

By: Glenn Dub Date: 9/22/17