



No. 00 207

JACKSONVILLE WASTEWATER UTILITY

248 Cloverdale Road • P.O. Box 69

Jacksonville, AR 72078-0069

982-0581

RESIDENTIAL OR COMMERCIAL BUILDING SEWER CONNECTION PERMIT

Street Address 8 Warehouse Row

Legal Description _____

Facility to be connected to sewer:

Single Family Residence _____ *Multi-family Residential _____ Units _____

*Commercial Installation _____ Description: _____

Water Meter (s) Size _____

* Commercial installations, and multi-family installations of more than 4 dwelling units must be accompanied by a site plan showing the proposed building sewer.

Sewer line installation by Nelson Plumbing

Address _____

General

Address _____

In consid

1. To ac

2. To m
public

3. To ne
to the

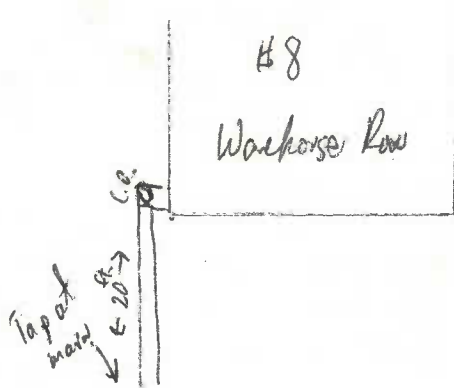

Fees:

Inspection Fee \$ 6.00

Receipt No. 7272

Total Fees \$ _____

APPLICANT

Signed Deborah Jones - Tracy

☒ Plumbing Contractor

☐ General Contract

☐ Owner (Address _____)

APPROVED

Jacksonville Wastewater Utility

By: Allen H. Lewis

Date: 5-18-02